

# SPREE FUMÉE

SHIP RESTAURANT & BAR

[ EVENT PORTFOLIO ]

Märkisches Ufer 1Z, 10179 Berlin  
[ Historischer Hafen Berlin ]

SUN-WED 12:00-00:00  
DON-SAT 12:00-01:00

T: +49 (0)30 2201 9294  
E: ahoi@spree-fumee.de

WEBSITE 

INSTAGRAM 

# [ CONTENTS ]

**ABOUT US** P. 03

**SPACES** P. 04

Upper Deck terrace P. 05

Lower Deck dining room P. 08

**CULINARY** P. 11

**DRINKS** P. 13

**EQUIPMENT** P. 15

**CONTACT** P. 16

# WELCOME ABOARD THE SHIP RESTAURANT & BAR [ SPREE FUMÉE ]

Located in the heart of the historic harbor on the Spree, this unique venue blends maritime history with modern design. A ship restaurant & bar, a terrace on the water, and a gathering place for soulful evenings – offering views of the Spree and the Berlin TV Tower.

This is where maritime nostalgia meets urban ease. A relaxed atmosphere meets culinary craftsmanship. Our kitchen serves Asian tapas from steam baskets and the charcoal grill – light, aromatic, and perfect for sharing. At the bar, we craft unique cocktails inspired by classic recipes and modern influences.

A place that lives, connects, and surprises – from dinner by the water to special events for up to 300 guests. Come on board and discover the possibilities of the Ship Restaurant & Bar Spree Fumée.

# [ OUR SPACES ] ON BOARD

Our event spaces offer total flexibility – from the open-air Upper Deck with its terrace to the cozy Lower Deck dining room indoors. Both areas are available for private hire for celebrations, special occasions, or relaxed evenings, providing a one-of-the-kind ambiance on the River Spree.



# [ UPPER DECK TERRACE ]

Usable area: 200 m<sup>2</sup>  
Capacity: 150 guests

Floating directly above the Spree with views of the Berlin TV Tower, the Upper Deck is the place for relaxed moments and social gatherings. Accommodating up to 150 guests, the terrace is perfect for sunny days, pleasant summer evenings, and unforgettable memories.

Enjoy fresh Asian tapas, extraordinary drinks, and a unique flair right on the water.



# [ UPPER DECK TERRACE ]

Usable area: 200 m<sup>2</sup>  
Capacity: 150 guests

With 200 m<sup>2</sup> and space for up to 150 guests, the Upper Deck offers an extraordinary event setting against the backdrop of Berlin and the sunset. Terraces 1–3 create distinct zones for intimate dinners, refreshing drinks at the bar, and an open kitchen with a grill that invites you to watch the chefs at work. A dedicated DJ booth and flexible layout options round out the experience. Whether relaxing in the shade or feeling the energy of the city – the Upper Deck is the perfect location for special experiences in great company.

## TERRACE 1

70 m<sup>2</sup>  
80 guests

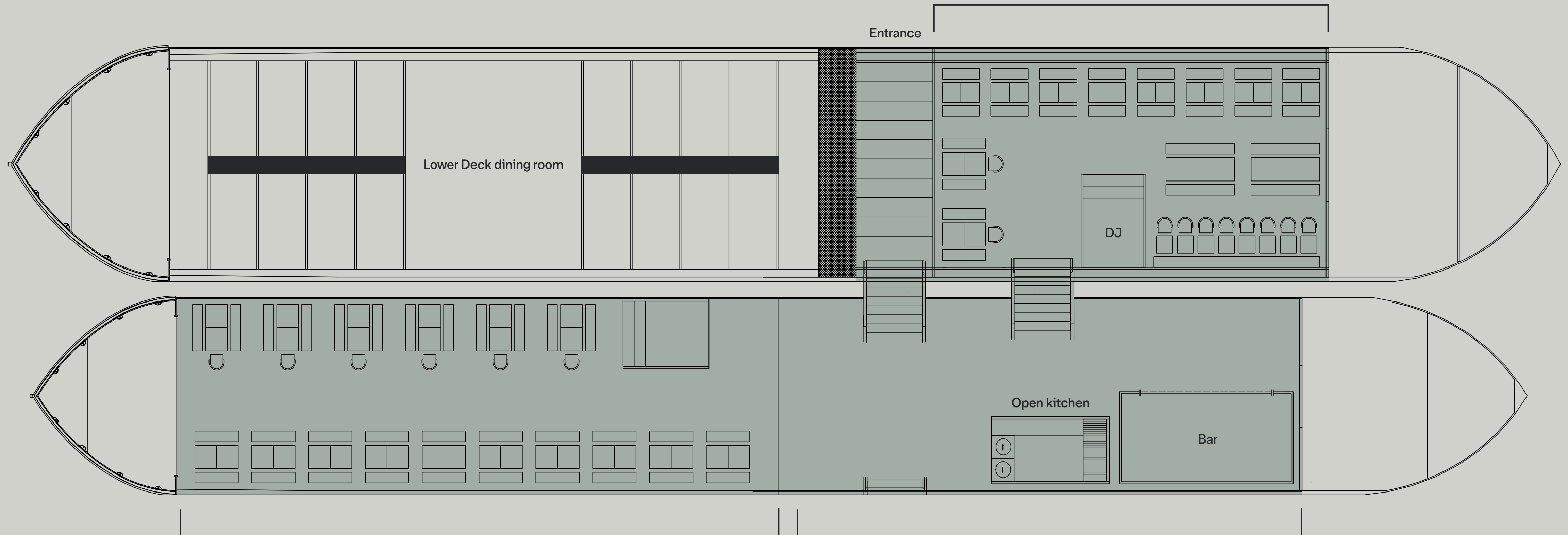

## TERRACE 2

70 m<sup>2</sup>  
70 guests

## TERRACE 3

60 m<sup>2</sup>

# [ UPPER DECK TERRACE ] IMPRESSIONS

Usable area: 200 m<sup>2</sup>  
Capacity: 150 guests



# [ LOWER DECK DINING ROOM ]

Usable area: 70 m<sup>2</sup>  
Capacity: 90 guests

With 140 m<sup>2</sup> and capacity for up to 90 guests, the Lower Deck dining room offers maritime flair, a stylish bar, and a cozy atmosphere – the ideal spot for exclusive dinners, drinks, and lively celebrations. Its flexible design creates space for culinary delights, conversation, and special moments.



# [ LOWER DECK DINING ROOM ]

Usable area: 70 m<sup>2</sup>  
Capacity: 90 guests

Across 70 m<sup>2</sup>, the Lower Deck dining room accommodates up to 90 guests, impressing with its maritime charm, elegant bar, and modern design. A separate restroom area provides added convenience. From stylish receptions and dinners to social gatherings – this unique space adapts to any occasion, creating a special atmosphere for enjoyment, dialogue, and unforgettable encounters.

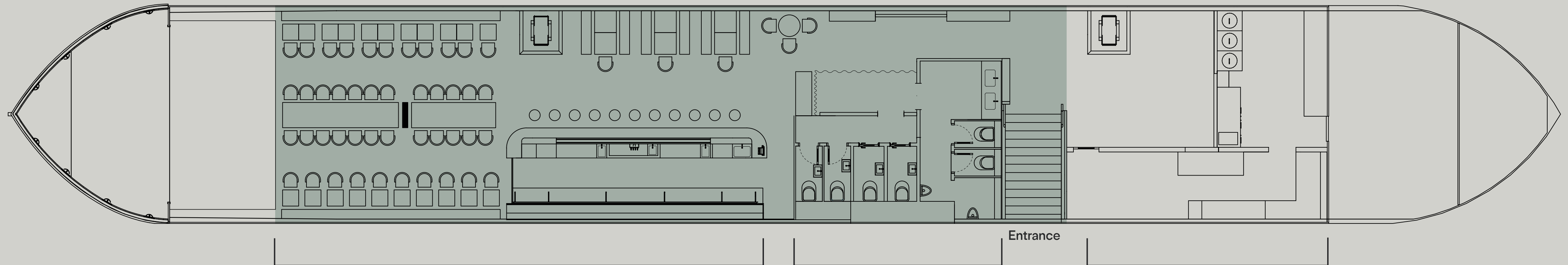

## DINING ROOM & BAR

70 m<sup>2</sup>  
90 guests

## WC

## KITCHEN

# [ LOWER DECK DINING ROOM ] IMPRESSIONS

Usable area: 70 m<sup>2</sup>  
Capacity: 90 guests



# [ CULINARY ]



# [ TAPAS ] REINTERPRETED

Floating Flavors - our concept for creative enjoyment on the Spree. Asian tapas, steamed or grilled, refined plated dishes and surprising drinks: everything developed to combine taste, aroma and community in perfect sharing-style.



# [ DRINKS ]



# STORIES [ IN A GLASS ]

Our Cocktail Map takes you on a journey to Berlin's bridges: Each drink bears their name and connects tradition with modern enjoyment. From classic favorites to creative signature creations - including non-alcoholic options - the bar offers aromatic highlights for every taste.



# FACILITIES & INFRASTRUCTURE

- Wifi
- High-voltage power
- Sound system / Microphone
- DJ equipment
- On-site kitchen
- Ground-level truck access
- Sun-protected outdoor area

Additional dishes, furniture and equipment can be booked.



**FOR [ CONSULTATION ] AND [ PERSONALIZED PLANNING ]  
WE ARE HAPPY TO ASSIST YOU.**

[ Spree Fumée ] — Ship Restaurant & Bar

[ Inquiries ]

1 – 40 people

40 – 300 people and exclusive events

[click here](#)

[click here](#)

Give us a call to check availability.

**T: +49 (0)30 2201 9294**

**E: ahoi@spree-fumee.de**